



Parking Brake

Inspection

1. Pull the parking brake lever with 200 N (20 kgf, 44 lbf) force to fully apply the parking brake. The parking brake lever should be locked within the specified notches.

Lever Locked Notches:

Cars With Rear Disc Brake: 7-11

Cars With Rear Drum Brake: 4-8

Pulled up with 200 N (20 kgf, 44 lbf)

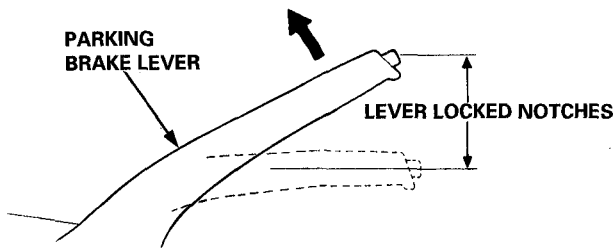

2. Adjust the parking brake if the lever notches are out of specification.

Adjustment

NOTE: After rear brake caliper servicing, loosen the parking brake adjusting nut, start the engine, and depress the brake pedal several times to set the self-adjusting brake before adjusting the parking brake.

1. Raise the rear wheels off the ground and support on safety stands.

⚠ WARNING Block the front wheels before jacking up the rear of the car.

2. Make sure the parking brake arm on the rear brake caliper contacts the brake caliper pin.

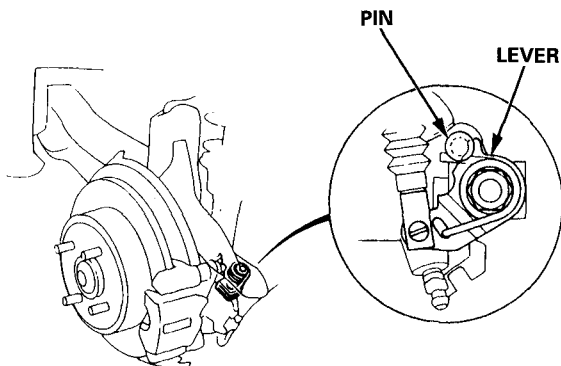

3. Pull the parking brake lever up one notch.

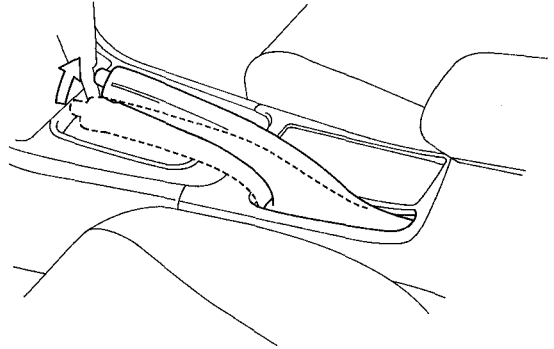

4. Remove the rear console (see [section 20](#)).

5. Tighten the adjusting nut until the rear wheels drag slightly when turned.

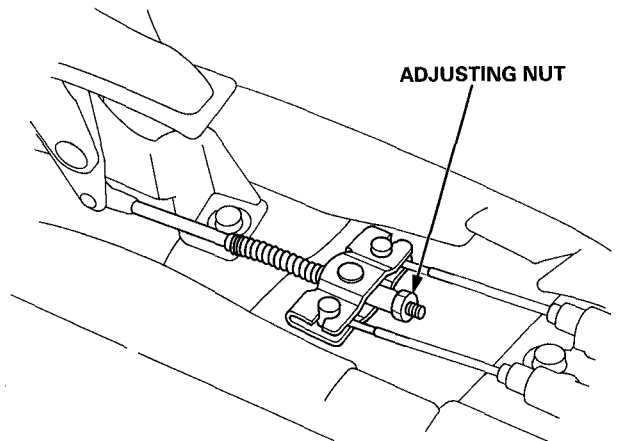

6. Release the parking brake lever fully, and check that the rear wheels do not drag when turned. Readjust if necessary.
7. Make sure that the parking brakes are fully applied with the parking brake lever is pulled up fully.
8. Install the cap onto the parking brake cable end, and reinstall the rear console.